

NORTH

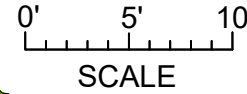

MAIN FLOOR
1030 SQ. FT.
9'-0" CEILING

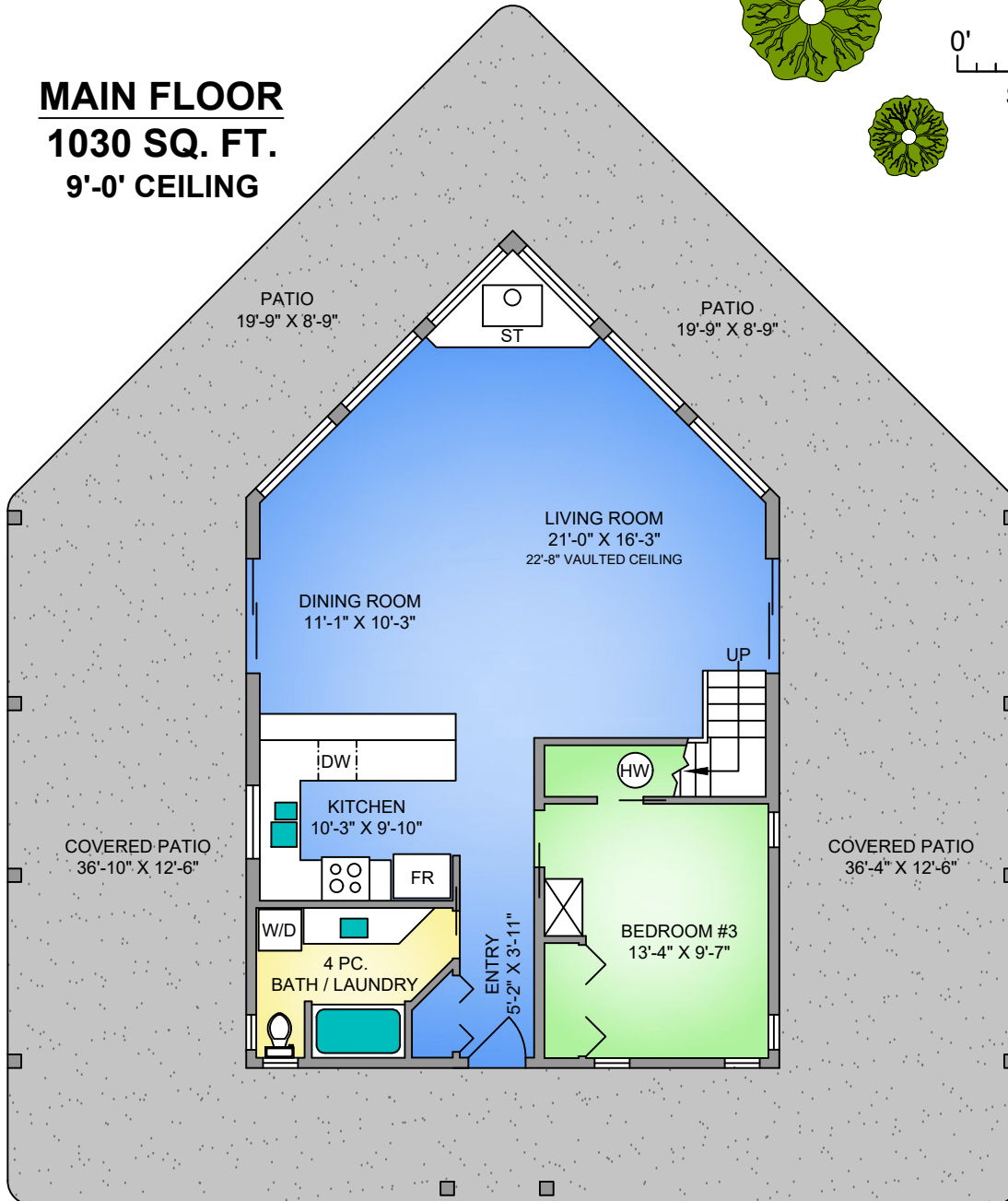

UPPER FLOOR
540 SQ. FT.

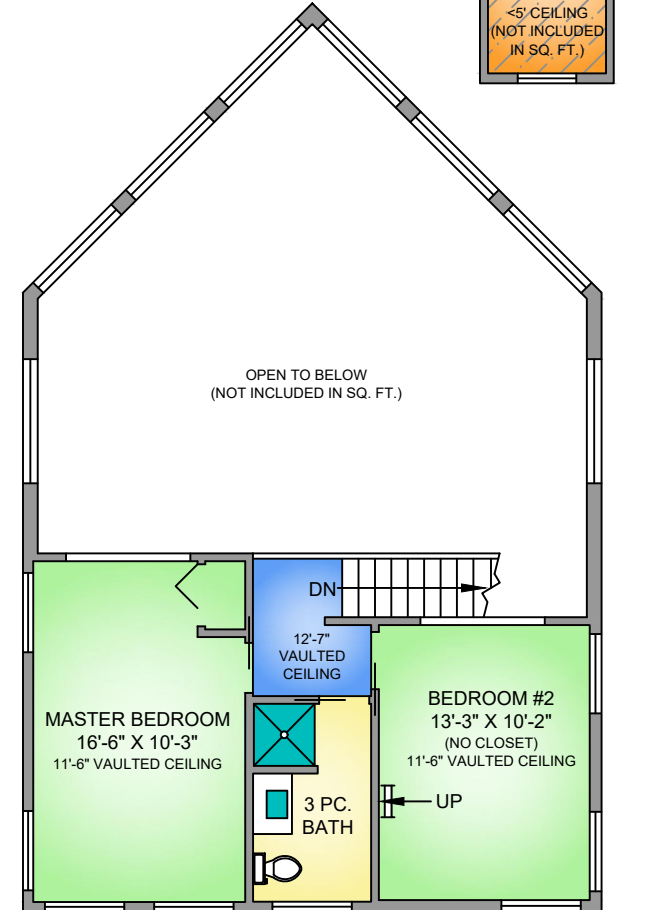

201 DANIEL WAY
 JUNE 19, 2018

Prepared by PROPER MEASURE MID ISLAND for the exclusive use of MARTIN VELSEN TEAM
 Plans may not be 100% accurate. Buyer must verify any critical measurement.
 Private resale or modification of floor plans to a third party by any individual or entity other than
 Proper Measure Mid Island is strictly prohibited

FLOOR	AREA (SQ. FT.)		
	FINISHED	UNFINISHED	DECK / PATIO
MAIN	1030	-	1421
UPPER	514	-	-
TOTAL	1544	-	1421
SHED	-	187	-
GARAGE	-	902	-

REAL ESTATE TEAM

GARAGE 902 SQ. FT.

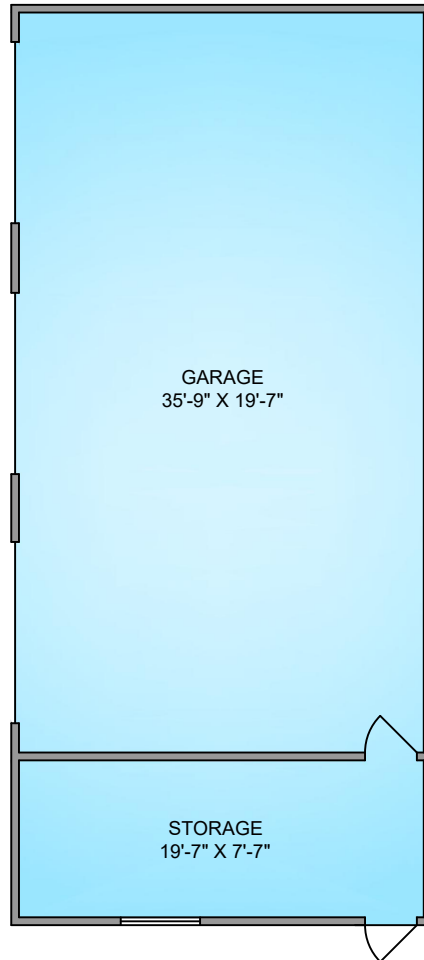

SHED 187 SQ. FT.

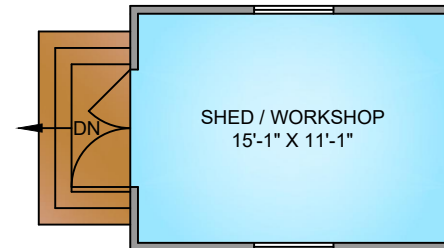

NORTH

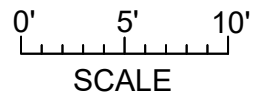

201 DANIEL WAY JUNE 19, 2018			
Prepared by PROPER MEASURE MID ISLAND for the exclusive use of MARTIN VELSEN TEAM Plans may not be 100% accurate. Buyer must verify any critical measurement. Private resale or modification of floor plans to a third party by any individual or entity other than Proper Measure Mid Island is strictly prohibited			
FLOOR	AREA (SQ. FT.)		
	FINISHED	UNFINISHED	DECK / PATIO
MAIN	1030	-	1421
UPPER	514	-	-
TOTAL	1544	-	1421
SHED	-	187	-
GARAGE	-	902	-